

FOR PUMPS WITH S/N 7.5P, 9P AND 11P

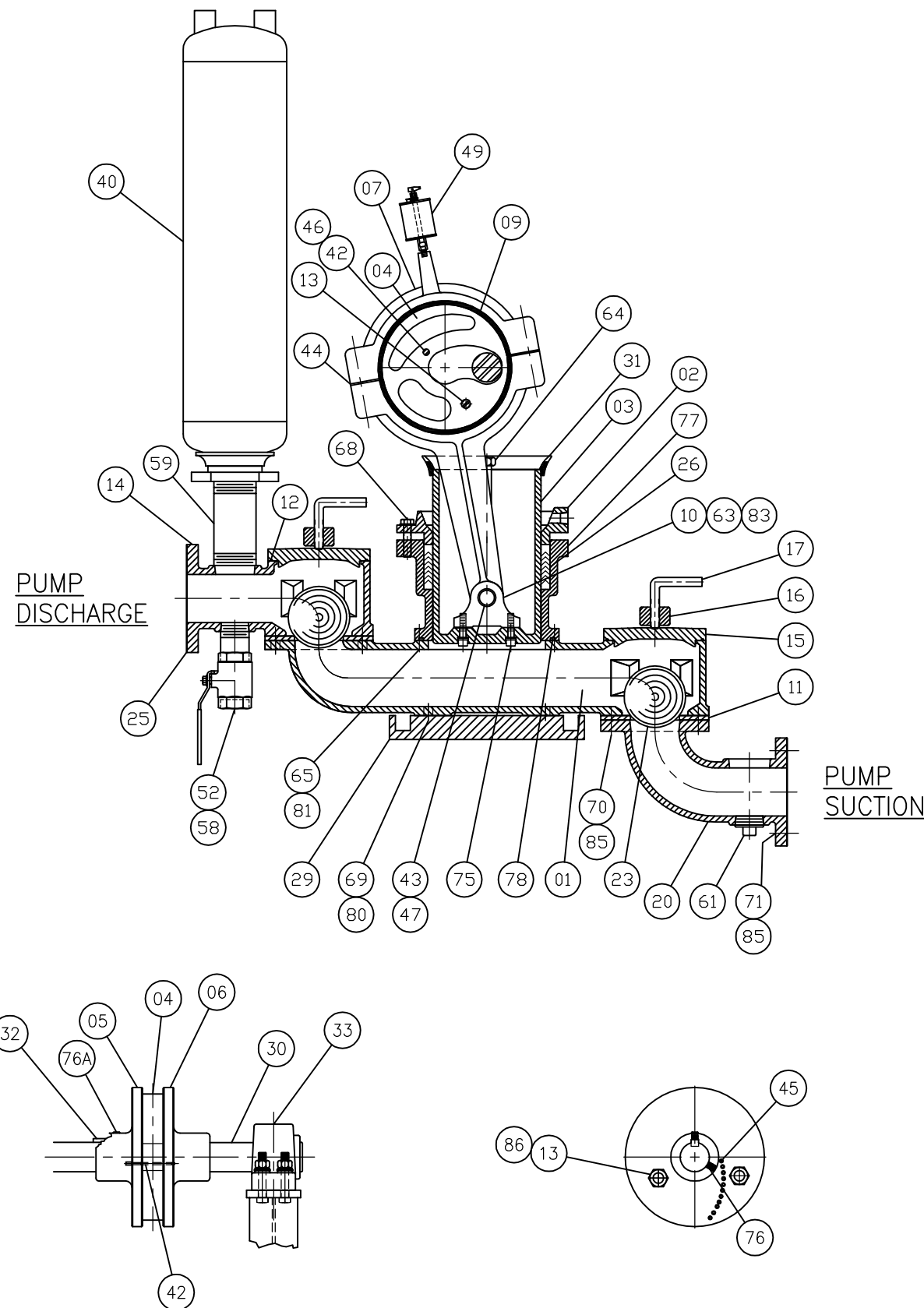

MATERIAL LIST		
ITEM	DESCRIPTION	MATERIAL
01	PUMP BODY	CAST IRON, ASTM A48, CLASS 30
02	PACKING GLAND	CAST IRON, ASTM A48, CLASS 30
03	PLUNGER, HARDENED OR COATED	CAST IRON, ASTM A48, CLASS 40
04	ECCENTRIC	CAST IRON, ASTM A48, CLASS 40
05	FLANGE, ECCENTRIC, DRIVE	CAST IRON, ASTM A48, CLASS 40
06	FLANGE, ECCENTRIC DRIVEN	CAST IRON, ASTM A48, CLASS 40
07	CONNECTING ROD ASSY	CAST IRON, ASTM A48, CLASS 40
09	ECCENTRIC BEARING LINER	MARINE GRADE BABBIT
10	BRACKET, WRIST PIN	CAST IRON, ASTM A48, CLASS 30
11	VALVE SEAT, REPLACEABLE	RUBBER OR SS
12	O-RING, VALVE CHAMBER COVER	RUBBER, BUNA-N
13	STUD, ECCENTRIC	STEEL
14	VALVE CHAMBER, DISCHARGE, LONG	CAST IRON, ASTM A48, CLASS 30
15	COVER, VALVE CHAMBER	CAST IRON, ASTM A48, CLASS 30
16	YOKE, VALVE CHAMBER	CAST IRON, ASTM A48, CLASS 30
17	YOKE SCREW, VALVE CHAMBER	STEEL, CF
20	ELBOW, SUCTION, LONG	CAST IRON, ASTM A48, CLASS 30
23	VALVE BALL, W/ STEEL CORE	URETHANE RUBBER, DURO 90-93
25	GASKET, FLANGE, 1/16"	FIBER, CORK
26	PACKING, 3/4"	PACKING SET
29	PUMP BASE w/ DRIP LIP	STEEL, HR A36
30	PUMP SHAFT	STEEL, T, G & P
31	EXTENSION RING, 9"	CAST IRON, ASTM A48, CLASS 30
32	KEY, MAIN SHAFT DRIVE FLANGE	STEEL
33	BEARING, MAIN SHAFT, PILLOW BLOCK	BALL OR SPHERICAL ROLLER
40	AIR CHAMBER	STEEL, GALVANIZED
42	SHEAR PIN	STEEL
43	WRIST PIN	ROUND, CFS, HEAT-TREATED, 4140/4142, 2-1/4" DIA
44	SHIMS, CONNECTING ROD	BRASS
45	BUSHING, DRIVE FLANGE	STEEL HARDENED
46	BUSHING, ECCENTRIC	STEEL HARDENED
47	BUSHING, WRIST PIN	BRONZE
49	DILER, CUP TYPE, 5 OUNCE	BRASS & GLASS
52	VALVE, PLUG, 2"	BRONZE
58	NIPPLE, 2" NPT X 3"	STEEL, GALV.
59	NIPPLE, 3"	STEEL, GALV. (9" OR 16")
61	PLUG, SQ HD, CORED, THREADED, 2" NPT	CAST IRON, ASTM A48, CLASS 30
63	SCREW, SET, SQ HD, CUP PT, 3/8"-16x1-1/2"	STEEL
64	DRAIN ROD, PLUNGER	STEEL, HR A36
65	BOLT, HX HD, 3/4"-10 x 2"	STEEL, ZINC PLATED
68	CAPSCREW, PACKING GLAND	STEEL, ZINC PLATED
69	BOLT, HX HD, 5/8"-11 x 2"	STEEL, ZINC PLATED
70	BOLT, HX HD, 5/8"-11 x 3"	STEEL, ZINC PLATED
71	BOLT, HX HD, 5/8"-11 x 2-3/4"	STEEL, ZINC PLATED
75	SCREW ASSY, PLUNGER TO BRACKET	STEEL, ZINC PLATED
76	SCREW, SET, SQ. HD, 5/8" X 3/4"	STEEL, ZINC PLATED
76A	SCREW, SET, SQ. HD, 5/8" X 5/8"	STEEL, ZINC PLATED
77	HOUSING, PLUNGER, KSS-9	CAST IRON, ASTM A48, CLASS 30
78	O-RING, HOUSING	RUBBER, BUNA-N
80	WASHER, LOCK, 5/8"	STEEL, ZINC PLATED
81	WASHER, LOCK, 3/4"	STEEL, ZINC PLATED
83	NUT, HX, 3/8-16	STEEL, ZINC PLATED
85	NUT, HX, 5/8-11	STEEL, ZINC PLATED
86	NUT, HX, 7/8"	STEEL, A194 GR 2H, 7/8"-9

REV	DRWN	CHKD	DATE	APPR	THIS DRAWING IS PROPRIETARY PROPERTY OF THE KOMLINE-SANDERSON ENGINEERING CORPORATION. IT IS LOANED IN CONFIDENCE AND MUST BE RETURNED ON DEMAND. ANY USE DETRIMENTAL TO THE INTERESTS OF KOMLINE-SANDERSON ENGINEERING CORPORATION IS PROHIBITED. IT MUST NOT BE LOANED, COPIED OR REPRODUCED WITHOUT PERMISSION.			
TITLE					VALVE & PLUNGER ASSY KSS SERIES SINGLE VALVE CROSS SECT.			
DESIGNED BY		DRAWN BY		CHECKED BY		APPROVED BY		
JWD		JWD		-		-		
DATE		SCALE		REFERENCE:		SHT		
24-OCT-13		1=8		KOMLINE-SANDERSON ENGINEERING CORPORATION PEAPACK, NJ 07977 USA		DRAWING NO. REV 1 OF 1		

PRINT MAY BE REDUCED SIZE, DO NOT SCALE. □□□□□□=ONE INCH(1")